

Freo Curved Vanity

Product Specifications



Pictured: Freo Curve Vanity, Shaker profile, American Oak Light, Quantum Quartz Alpine White Stone 40mm Top with radius ends
Available in Rattan Profile and Terazzo Stone Top also available

Standard sizes (L/W/H)

1200 × 500 × 750
(including 40mm stone)
(2 drawer, 2 door unit – single basin)
Total height 900mm to top of basin

1500 × 500 × 750
(including 40mm stone)
(2 drawer, 2 door unit – single/double basin)
Total height 900mm to top of basin

1800 × 500 × 750
(including 40mm stone)
(2 drawer, 2 door unit – single/double basin)
Total height 900mm to top of basin

Front view

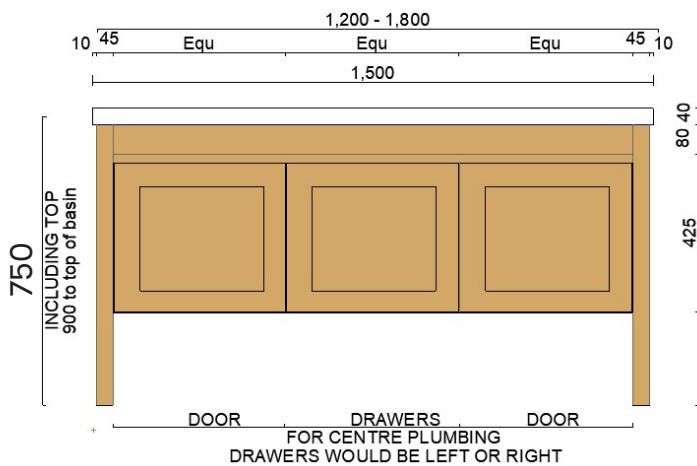

Plumbing location

	1200	1500	1800
Centre	600	750	900
Left/Right	300	375	450

Front Section

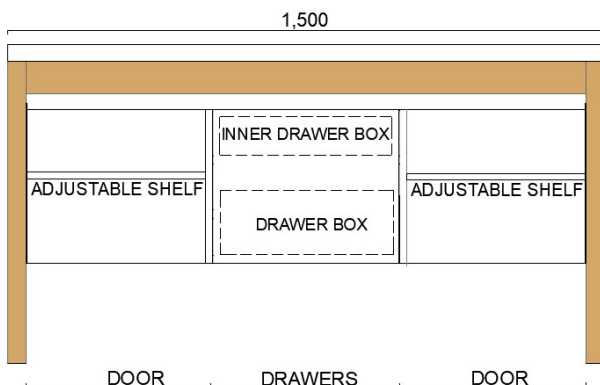

Section

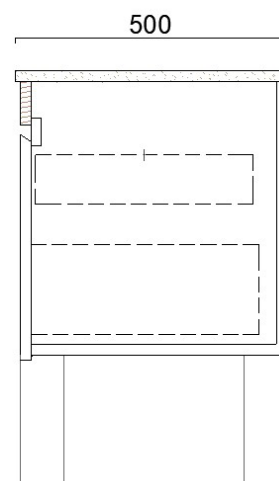

Freo Single Curved Vanity

Product Specifications



Standard sizes (L/W/H)

750 × 500 × 750
(including 40mm stone)
 (2 door unit – single basin)

900 × 500 × 750
(including 40mm stone)
 (2 door unit – single basin)

Pictured: Freo Curve Vanity, Shaker profile, American Oak Light, Quantum Quartz Alpine White Stone 40mm Top with radius ends
 Available in Rattan Profile and Terazzo Stone Top also available

Front view

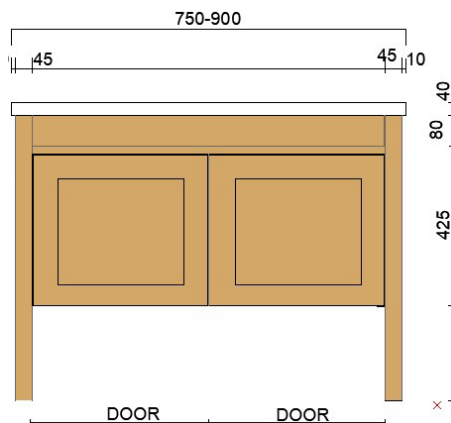

Plumbing location

	750	900
Centre	375	450
Left/Right	225	

Front Section

