

# Freo Curved Vanity

## Product Specifications



Pictured: Freo Curve Vanity, Shaker profile, American Oak Light, Quantum Quartz Alpine White Stone 40mm Top with radius ends  
Available in Rattan Profile and Terazzo Stone Top also available

### Standard sizes (L/W/H)

**1200 × 500 × approx 770**  
(including 40mm stone)  
(2 drawer, 2 door unit – single basin)  
Total height 900mm to top of basin

**1500 × 500 × approx 770**  
(including 40mm stone)  
(2 drawer, 2 door unit – single/double basin)  
Total height 900mm to top of basin

**1800 × 500 × approx 770**  
(including 40mm stone)  
(2 drawer, 2 door unit – single/double basin)  
Total height 900mm to top of basin

### Front view

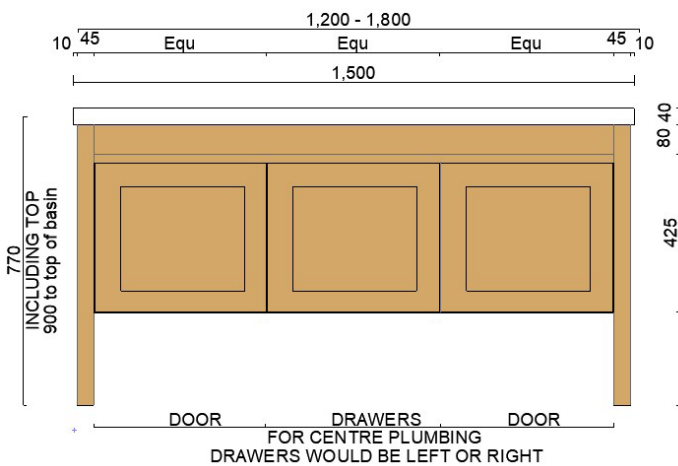

### Plumbing location

	1200	1500	1800
Centre	600	750	900
Left/Right	300	375	450

### Front Section

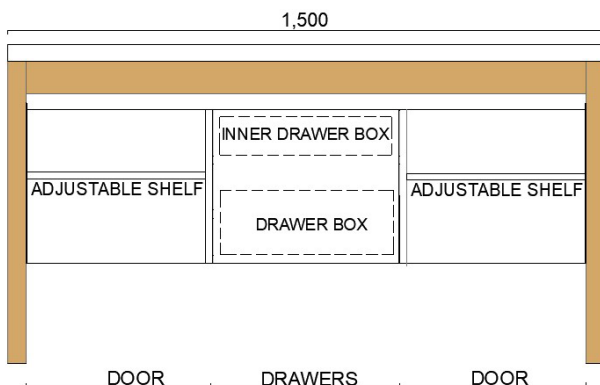

### Section

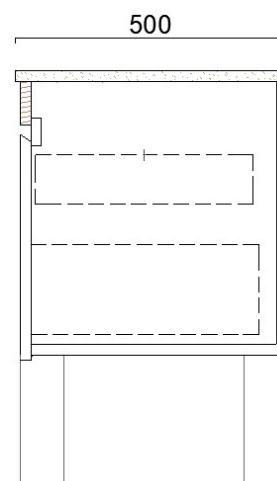

# Freo Single Curved Vanity

## Product Specifications



### Standard sizes (L/W/H)

**750 × 500 × approx 770**  
**(including 40mm stone)**  
 (2 door unit – single basin)  
 Total height 900mm to top of basin

**900 × 500 × approx 770**  
**(including 40mm stone)**  
 (2 door unit – single basin)  
 Total height 900mm to top of basin

Pictured: Freo Curve Vanity, Shaker profile, American Oak Light, Quantum Quartz Alpine White Stone 40mm Top with radius ends  
 Available in Rattan Profile and Terazzo Stone Top also available

### Front view

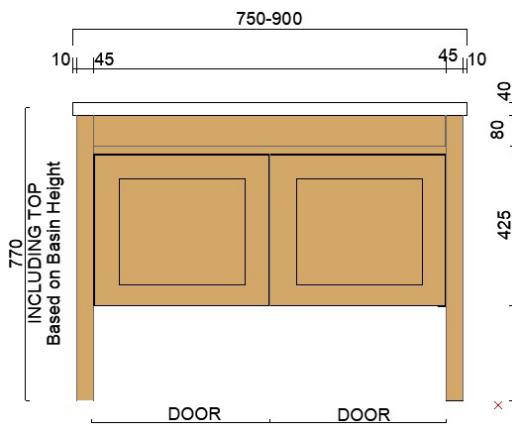

### Plumbing location

	750	900
Centre	375	450
Left/Right		225

### Front Section

