

Freo Freestanding Vanity Integrated Top

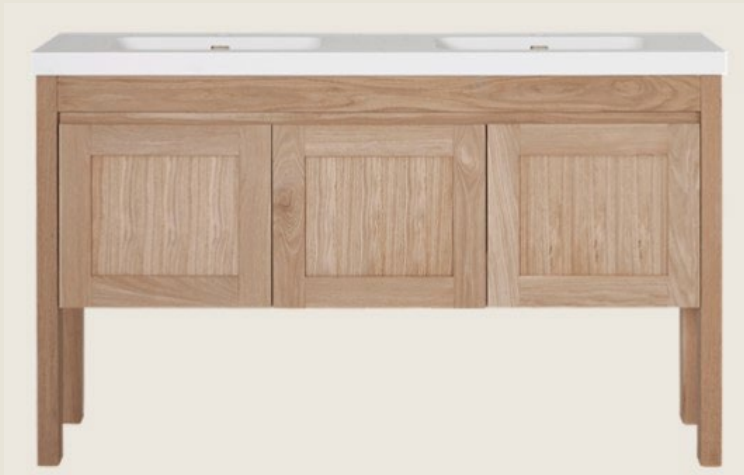

Product Specifications



Pictured: Freo Vanity, Shaker profile, American Oak Light, Solid surface top with twin cast-in basins

Available in Rattan and V-groove panel Profiles also

Standard sizes (L/W/H)

1200 × 460 × 880
(2 drawer, 2 door unit – single centre basin)

1500 × 460 × 880
(2 drawer, 2 door unit – double basin)

1800 × 460 × 880
(2 drawer, 2 door unit – double basin)

Plumbing location

	1200	1500	1800
Centre	600	/	/
Left/Right	/	385	450

Front view

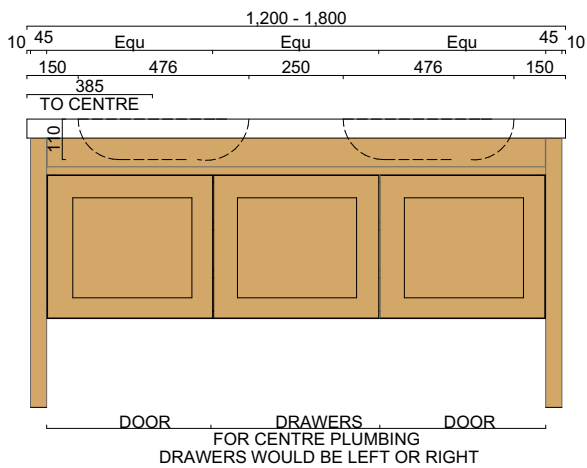

Section

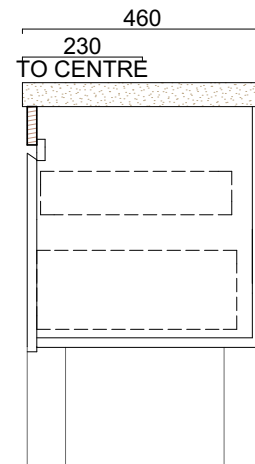

Top View

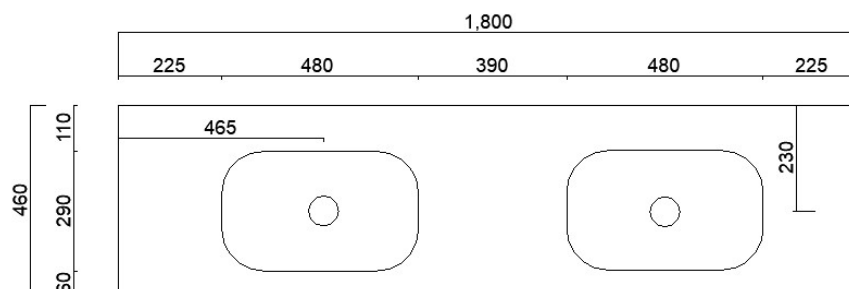
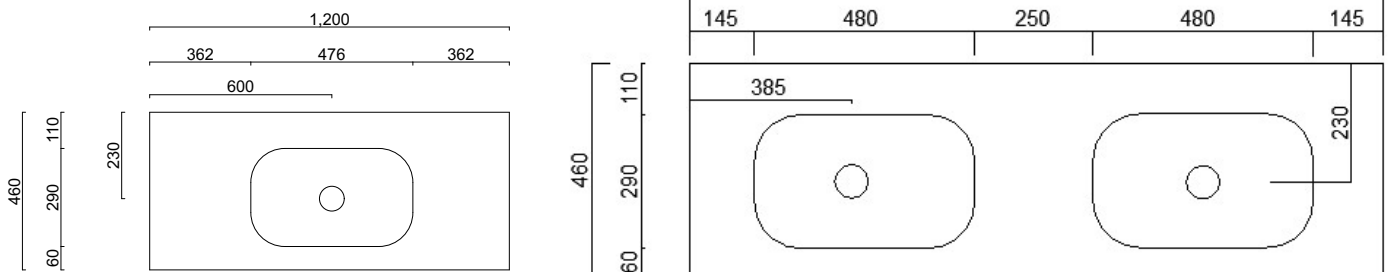

Freo Single Freestanding Vanity Integrated Top



Product Specifications

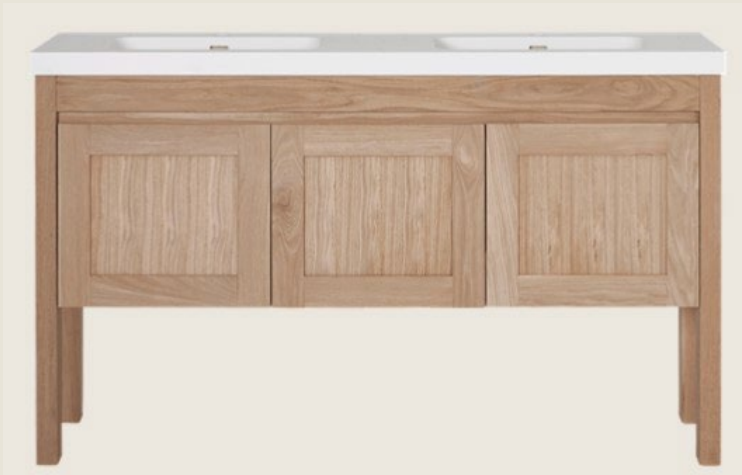

Pictured: Freo Vanity, Shaker profile, American Oak Light, Solid surface top with cast-in basins
Available in Rattan and V-groove panel Profiles also

Standard sizes (L/W/H)

750 x 460 x 880
(2 door unit – single basin)

900 x 460 x 880
(2 door unit – single basin)

Front view

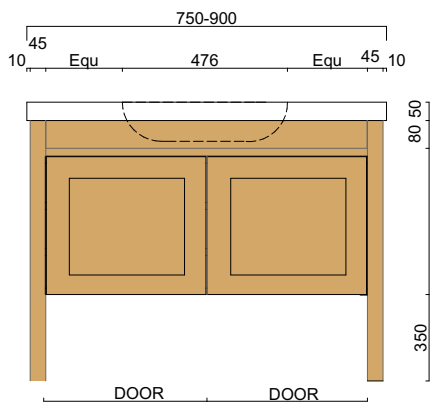

Plumbing location

	750	900
Centre	375	450

Front Section

